



B100a

TOWN OF RIDGEFIELD

Health Department

Plans for Sewage Disposal & Water Supply

Septic Plan Received 8/18/11 Application # HEA-2011-0202 Assess. # FIG-0012
 Lot # _____ House # 25 Address Boulder Hill Lane
 Owner Diane & Kevin Cummins Phone 203 438-1222
 Engineer _____ Phone _____
 Installer David Tinker Phone 203 537-7145 Lic. # 005 296

FEES PAID

Application Fee Paid \$ 100.00 Date 8/12/11 Check # 1831 Rec. # 14228
 Permit Fee Paid \$ _____ Date _____ Check # _____ Rec. # _____
 # Reinspections _____ X \$25.00 = Total Due \$ _____ Date Paid _____
 Well Permit Paid \$ _____ Date _____ Check # _____ Rec. # _____

Septic Plan Review

SYSTEM TYPE: New Repair Septic Addition Reserve for Building Addition
 Septic Tank Replacement Partial System Relocation
 WATER SUPPLY: Private Well Community Well Public Water
 SPECIAL INFO: Watershed Wetlands Foundation Drain Curtain Drain

	<u>Date/Reviewed</u>	<u>Approved</u>	<u>Rejected</u>
<u>[Signature]</u> Sanitarian	<u>8/18</u>	<input checked="" type="checkbox"/>	<input type="checkbox"/>

Reason Rejected/Revision Required: _____

Special Conditions on Permit: _____

Meets Code: Yes No
 Insufficient leaching area, _____ sq. ft. required, _____ sq. ft. provided
 Using existing septic tank, undersized, too close to building
 Does not meet MLSS Closer than 75 feet to well
 Reduced center to center spacing Other _____

Residential: # Bedrooms 5 Commercial: Estimated GPD Flow _____
 Other Design _____

Fill Required: Yes No Perc of Fill Required: Yes No
 Pump Test Required: Yes No

Review of Building Plans

Building plans which were received on _____ have been reviewed and approved for a _____ bedroom house.

Sanitarian _____ Date _____

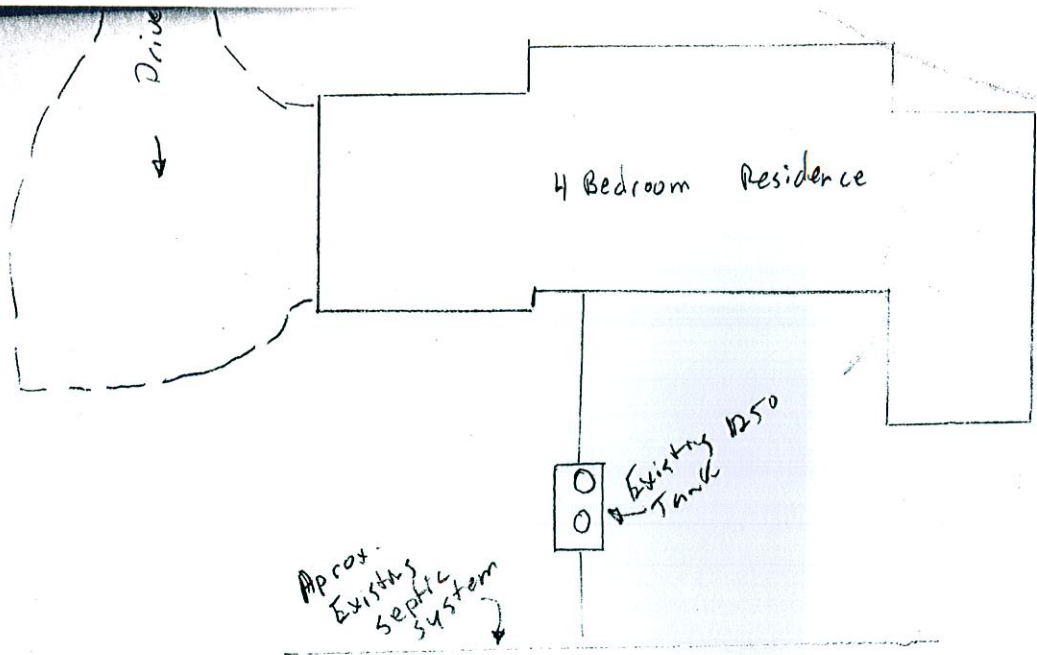

shed

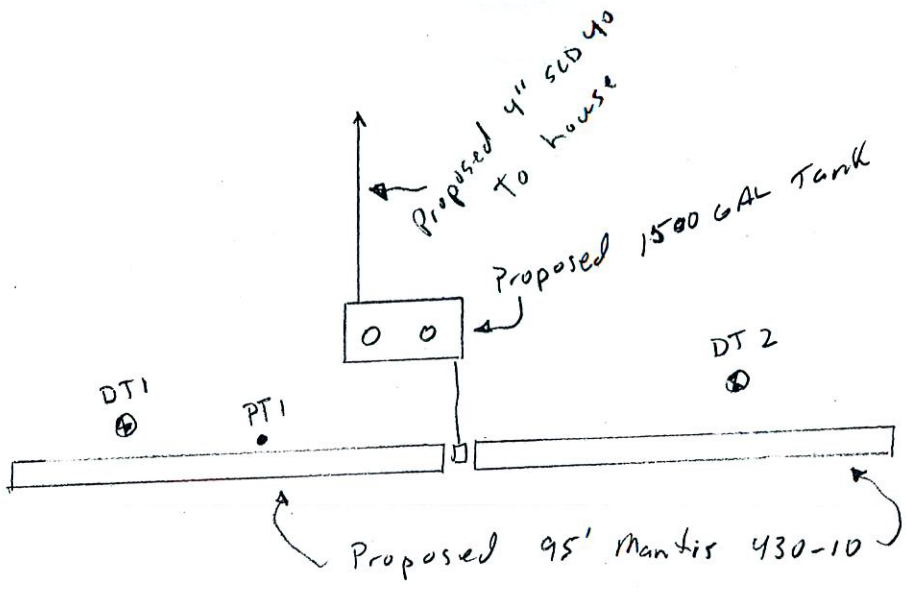

25 Boulder Hill Lane